

Cautions

- Ensure you fill in the Date Fitted Box (8) to allow you to monitor how long the Libra Conform has been in use. Change the Leg Bag every 5-7 days
- The Libra Conform should not be reused after disconnection from a catheter due to increased risk of infection
- Keep out of the reach of children
- Use of any medical device carries associated risks. Device failures are rare, however in the event of a device failure of this product, you should contact Great Bear Healthcare using the details provided within this leaflet
- If a failure has resulted in a serious incident, such as significant deterioration of health or death, you should contact Great Bear Healthcare and your local Competent Authority as soon as possible. Details of your local Competent Authority can be found on your local government website

Order Codes

Libra Conform Leg Bag – Prescription

All Prescription Libra Conform come with Fabric Backing and one pair of Leg Bag Straps as standard

Code	Capacity	Tube Length	Qty
10114Q	500ml	Short Tube (10cm)	10
10115R	500ml	Long Tube (30cm)	10
10116S	750ml	Short Tube (10cm)	10
10117T	750ml	Long Tube (30cm)	10



Products available through Nightingale Home Delivery Service

1. Call **Freephone 0800 304 7434**
2. Please ensure you have your GP details to hand.
3. Tell us which products are required and how many.

That's all – we will do everything else!

Please make sure you have at least two week's supply in hand before re-ordering.



Libra[®] Conform Leg Bag

Instructions For Use



Great Bear Healthcare Ltd
1 Lambourne Crescent,
Cardiff Business Park,
Cardiff, CF14 5GF
T +44 (0) 29 2074 7770



MediReps Ltd

First Floor, Penrose One,
Penrose Dock, Cork City,
T23 KW81,
Ireland

mail@gbhl.co.uk
www.greatbearhealthcare.co.uk

LIBRACONFORMIUV6/2022



A UK manufacturer committed to Urology.

Your Libra® Conform Leg Bag

Libra Conform are for the daytime storage and drainage of urine.

Libra Conform is designed for maximum discretion and comfort, with three chambers to wrap around the contour of the leg.

Designed to be connected directly to a catheter or sheath for continuous drainage.

Libra Conform can also be connected to a Night Bag for overnight drainage (page 3).

Libra Conform should be changed every 5-7 days.

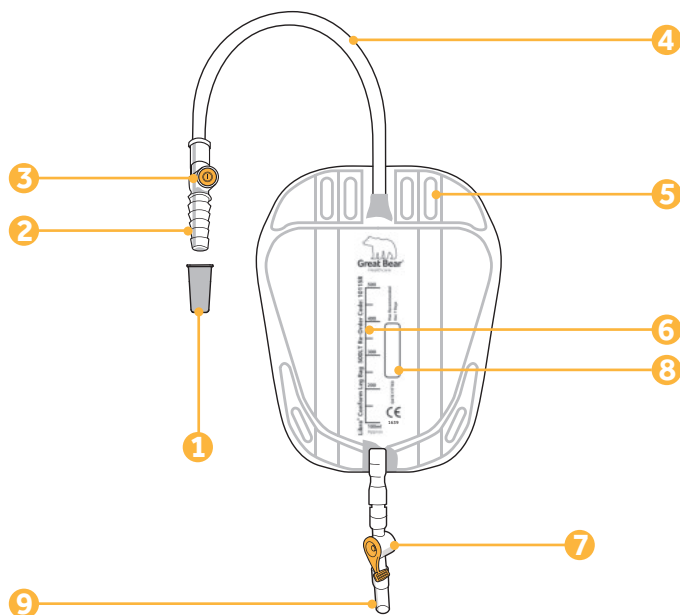

Key	
1 Protective Cap	6 Graduated Scale*
2 Ridged Inlet Connector	7 Outlet Tap
3 Needle Free Sample Port	8 Date Fitted Box
4 Inlet Tube	9 Silicone Sleeve
5 Eyelets	

* The graduated scale is an approximation and should not be used for accurate measurement of urine output

Instructions For Use

Before Use

- 1) Wash Hands
- 2) Open peel pouch and remove Libra Conform from its packaging
- 3) Ensure the lever on the outlet tap (7) is in the closed position (Diagram 1)
- 4) Remove the grey protective cap (1) from the Libra Conform inlet connector (2)

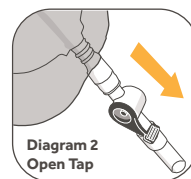
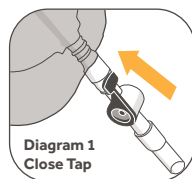

Direct Connection

- 1) Insert the ridged inlet connector (2) into the end of the Indwelling Catheter or Sheath. Insert the connector fully to allow a secure connection.
- 2) The Libra Conform should be positioned on the thigh or calf, depending on the tube length, and secured appropriately with the leg bag straps provided.
- 3) Feed the leg bag straps through the eyelets (5) on the bag and ensure the wavy silicone lines faces onto the leg.
- 4) Make sure the inlet tubing (4) isn't kinked which can restrict the flow of urine.

Emptying

- 1) Empty the Libra Conform by pushing the lever on the outlet tap (7) downwards (Diagram 2).
- 2) After emptying, wrap the outlet tap with a tissue and pat a number of times before gently wiping around the inside of the valve. This will dislodge any residual urine.
- 3) Remember to close the tap after emptying (Diagram 1).
- 4) The outlet tap (7) can be twisted to avoid accidental emptying.

Overnight Drainage

If you require additional drainage for overnight use, a night bag can be connected as part of an overnight link system.

- 1) When you go to bed, do not disconnect your Libra Conform from your Catheter or Sheath.
- 2) Insert the connector of your Night Bag to the silicone sleeve (9) on your Libra Conform. Insert the connector fully to allow a secure connection.
- 3) Once connected, turn the Libra Conform tap to the open position (Diagram 2) to allow the overnight drainage into the Night Bag.
- 4) Before disconnecting the Night Bag in the morning, ensure the Libra Conform tap is in the closed position (Diagram 1).

Storage and Disposal

- 1) The Libra Conform should be stored at an ambient temperature and allowed to come to room temperature before use.
- 2) Dispose with normal household waste – do not flush down the toilet.